



Ball-Lock

Ejector

Heavy-Duty

R = ○
O = ○
S = □
H = □

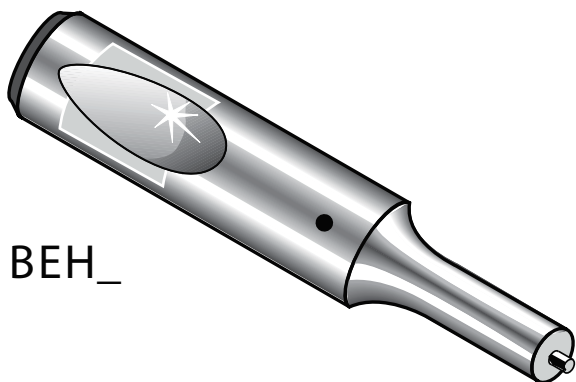

BEH_

Ordering Example:
(12) BEHR 13-13-71 M2 P10.1

Ordering Example:
(12) BEHO 20-19-80 M2 P18.2 W9.5 BS-90°

M2 R/c 60-63 triple tempered

Round P to D	0.01	⊙
Shape P&W to D	0.02	⊙

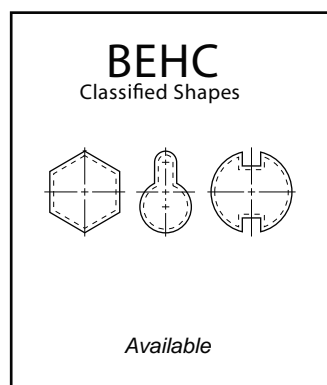
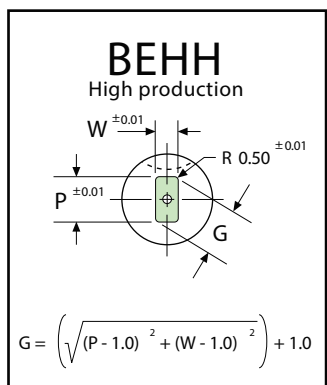
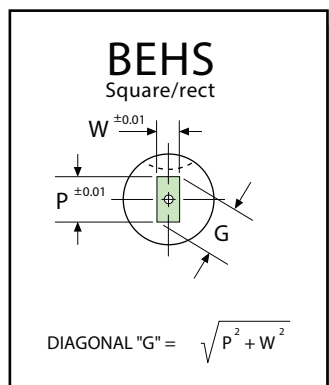
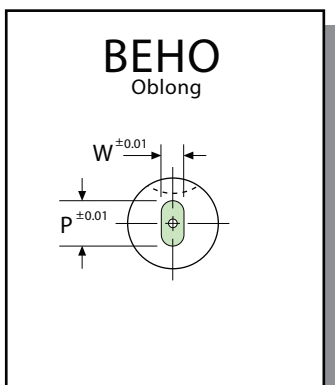
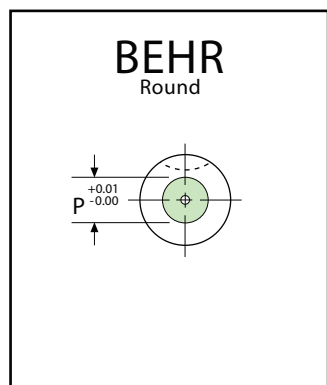
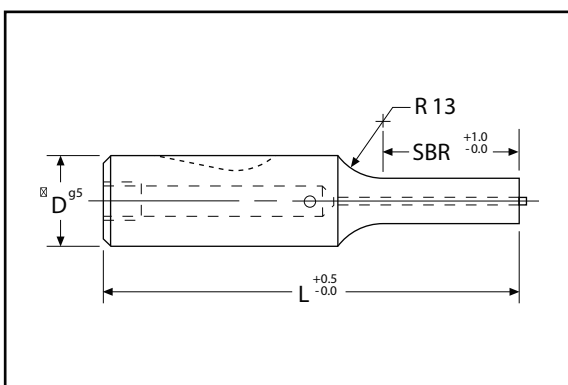
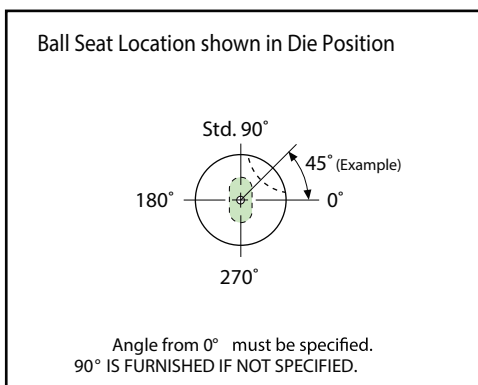

Type	"D"	Point Length "SBR"					Overall Length "L"							Round Min. "P"	Shape Min. "W"	Ejector Type
		10	13	19	25	32	63	71	80	90	100	110	125			
BEH_	10	10	13	19			63	71	80	90	100	110		2.9	2.9	E4M
BEH_	13		13	19			63	71	80	90	100	110	125	4.0	4.0	E6M
BEH_	16		13	19	25		63	71	80	90	100	110	125	6.0	6.0	E9M
BEH_	20		13	19	25		63	71	80	90	100	110	125	6.0	6.0	E9M
BEH_	25		13	19	25			71	80	90	100	110	125	8.0	8.0	E9M
BEH_	32		13	19	25			71	80	90	100	110	125	10.0	10.0	E12M
BEH_	40			19	25	32			80	90	100	110	125	12.0	12.0	E12M