

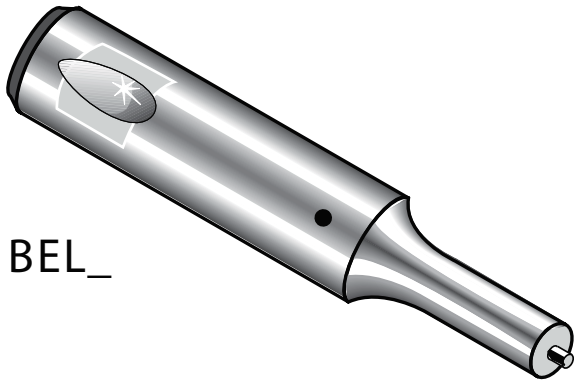

Ball-Lock

Ejector

Light-Duty

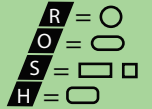

BEL_

Ordering Example:
(12) BELR 13-13-71 M2 P10.1

Ordering Example:
(12) BELO 20-19-80 M2 P18.2 W9.5 BS-90°

A2, R/c 60-63 double tempered
M2, R/c 60-63 triple tempered

Round P to D	0.01	
Shape P & W to D	0.02	

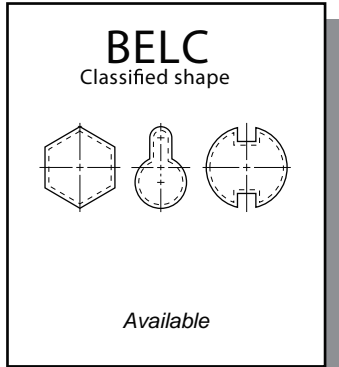
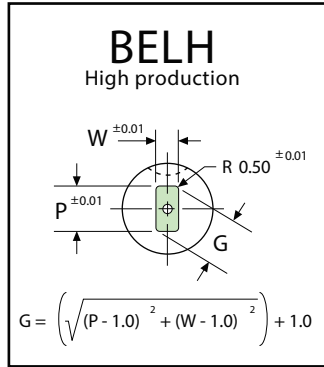
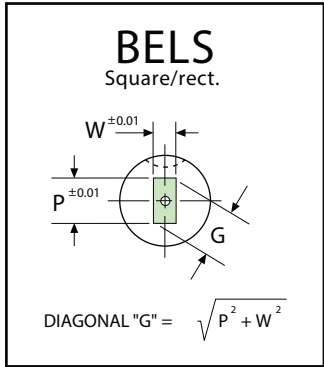
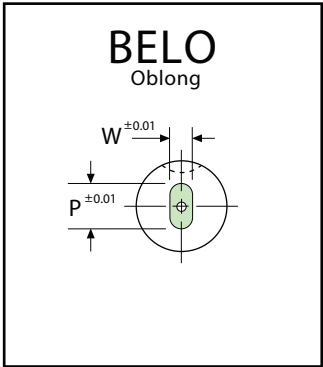
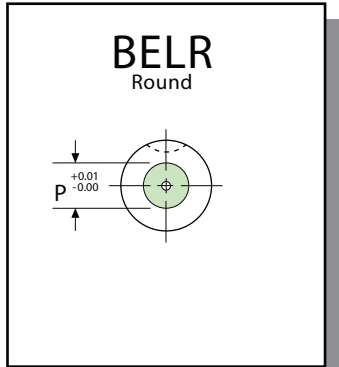
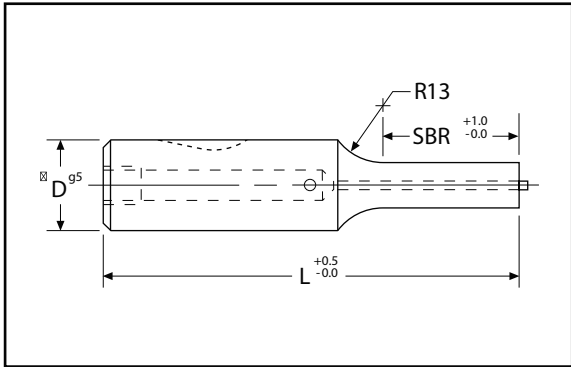
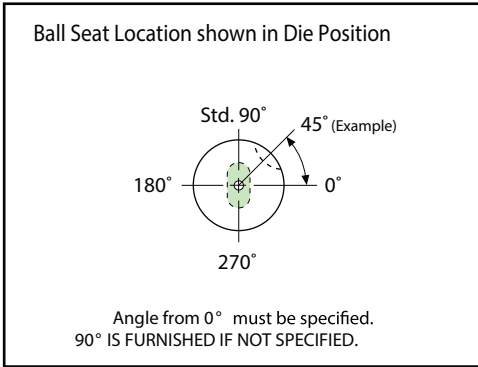

Type	"D"	Point Length "SBR"				Overall Length "L"							Round "P" min.	Shape "W" min.	Ejector Type
		8	13	19	25	50	56	63	71	80	90	100			
BEL_	6	8	13			50	56	63	71	80			1.9	1.9	E2AM
BEL_	10		13	19		50	56	63	71	80	90	100	2.9	2.9	E4M
BEL_	13		13	19		50	56	63	71	80	90	100	4.0	4.0	E6M
BEL_	16		13	19	25		56	63	71	80	90	100	6.0	6.0	E9M
BEL_	20		13	19	25		56	63	71	80	90	100	6.0	6.0	E9M
BEL_	25		13	19	25		56	63	71	80	90	100	8.0	8.0	E9M
BEL_	32		13	19	25				71	80	90	100	10.0	10.0	E12M
BEL_	38			19	25					80	90	100	12.0	12.0	E12M

L = 50, max. SBR = 13
L = 56, max. SBR = 19

Made better to last longer

All specifications, dimensions and design characteristics shown are subject to change without notice

Quality Craftsmanship Assured

Email: sales@diemouldequipment.com.au

Die Mould Equipment

Web: www.diemouldequipment.com.au

© The copyright in this material vests in Die Mould Equipment Pty Ltd and may not be reproduced, adapted or communicated without the express written permission of the copyright owner.