

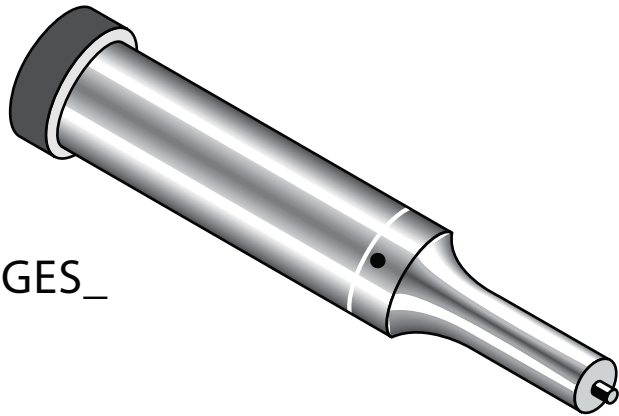

# General Ejector Shoulder

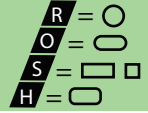

GES\_

**Ordering Example:**  
(12) GESR 13-13-71 M2 P10.1

**Ordering Example:**  
(12) GESO 20-19-80 M2 P18.2 W9.5 K4

A2, R/c 60-63 double tempered  
M2, R/c 60-63 triple tempered

Round P to D	0.01	
Shape P & W to D	0.02	

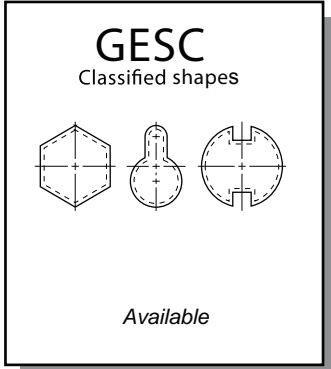
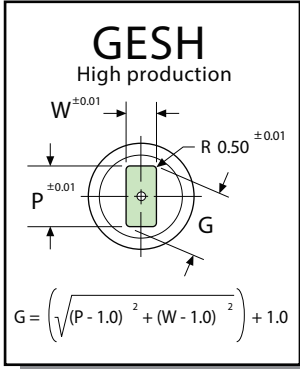
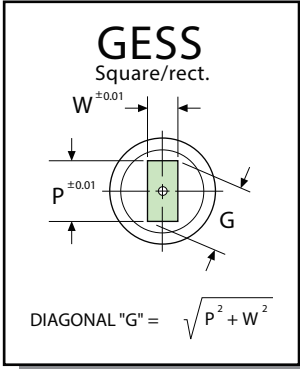
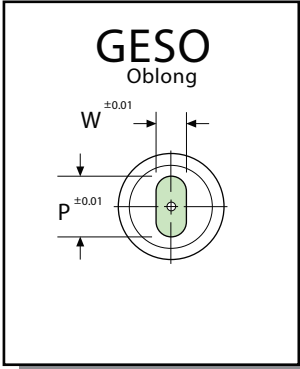
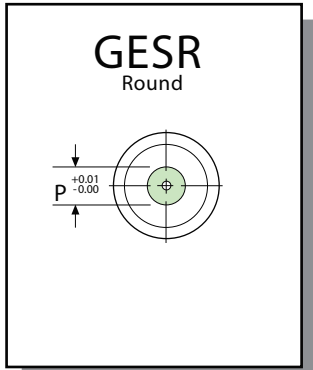
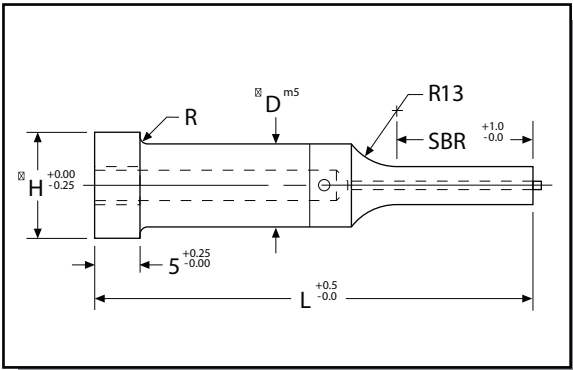
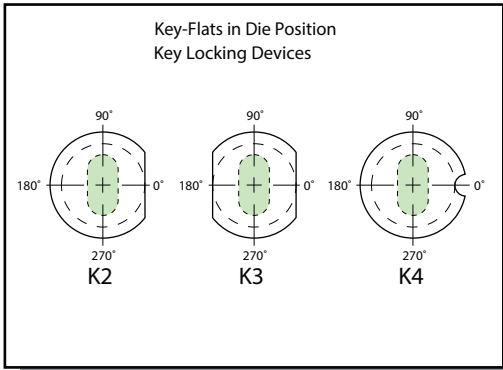

Type	"D"	Point Length "SBR"						Overall Length "L"						Round "P" min.	Shape "W" min.	Head Dia. "H"	Ejector Type	
		8	10	13	19	25	32	50	56	63	71	80	90					100
GES_	5	8	10	13			50	56	63	71				1.9	1.9	8	E2AM	
GES_	6	8	10	13			50	56	63	71	80			2.0	2.0	9	E3M	
GES_	8	8	10	13			50	56	63	71	80			2.9	2.9	11	E4M	
GES_	10		10	13	19		50	56	63	71	80	90	100	4.0	4.0	13	E6M	
GES_	13		10	13	19		50	56	63	71	80	90	100	4.0	4.0	16	E6M	
GES_	16			13	19	25		50	56	63	71	80	90	100	5.7	5.7	19	E9M
GES_	20			13	19	25			56	63	71	80	90	100	5.7	5.7	24	E9M
GES_	25			13	19	25			56	63	71	80	90	100	5.7	5.7	29	E9M
GES_	32				19	25	32				71	80	90	100	9.9	9.9	36	E12M
GES_	40				19	25	32					80	90	100	12.0	12.0	45	E12M
GES_	45					25	32					80	90	100	14.0	14.0	50	E12M
GES_	50					25	32					80	90	100	16.0	16.0	55	E12M
GES_	56					25	32					80	90	100	18.0	18.0	61	E12M
GES_	63					25	32					80	90	100	20.0	20.0	68	E12M

Made better to last longer

All specifications, dimensions and design characteristics shown are subject to change without notice

Quality Craftsmanship Assured

Email: sales@diemouldequipment.com.au

Die Mould Equipment

Web: www.diemouldequipment.com.au

© The copyright in this material vests in Die Mould Equipment Pty Ltd and may not be reproduced, adapted or communicated without the express written permission of the copyright owner.