

Recycling Inserts

U.S. Patent No. D324,392

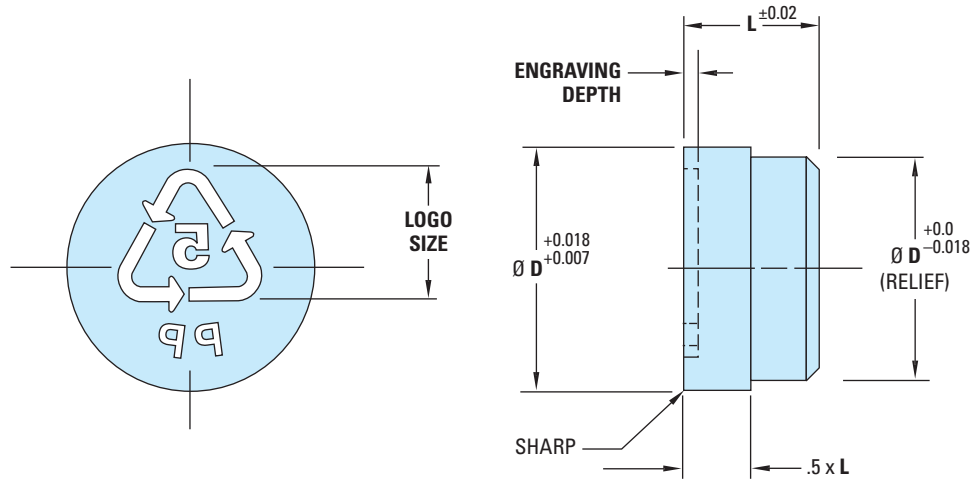
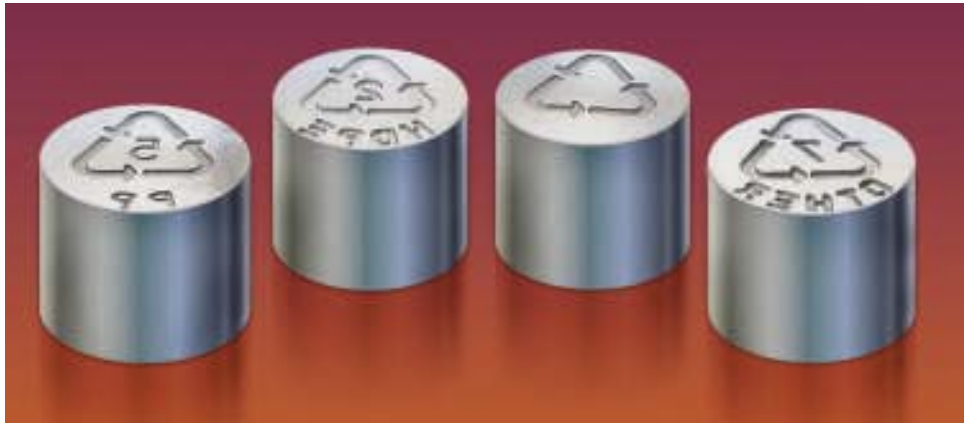

Benefits of Recycling Inserts

- Saves outsourcing and engraving costs
- Easily installed
- Easily interchanged
- Complies with SPI standards

Installation

- Press fit installation required.
- Maintain a close tolerance press fit. Too loose a fit could allow the insert to move out of position.
- Accurately measure the $\varnothing D$ for each part and machine hole to provide about 0.005mm (.0002") press fit.

INFORMATION KEY:

D = Outside Diameter**L** = Overall Length**Material:** See chart below**Hardness:** See chart below**Dimensions:** All dimensions are in mm

Recycling Inserts (Metric) – MRI

ITEM NUMBER	MATERIAL CODES (SPI STANDARD)	MATERIAL	HARDNESS	ENGRAVED LETTERING	MATERIAL IDENTIFICATION	$\varnothing D$	L	ENGRAVING DEPTH	LOGO SIZE
MRI0102	2	420 STAINLESS STEEL	48-52 HRC	HDPE	HIGH DENSITY POLYETHELENE	10	12	0.3	6
MRI0105	5			PP	POLYPROPYLENE				
MRI0107	7			OTHER	ALL OTHER RESINS				
MRI0100	—			ARROW SYMBOL ONLY	—				
MRI0202	2	420 STAINLESS STEEL	48-52 HRC	HDPE	HIGH DENSITY POLYETHELENE	16	14	0.3	10
MRI0205	5			PP	POLYPROPYLENE				
MRI0207	7			OTHER	ALL OTHER RESINS				
MRI0200	—			ARROW SYMBOL ONLY	—				
MRI0602	2	7075-7651 ALUMINUM	145-155 BRINELL	HDPE	HIGH DENSITY POLYETHELENE	20	16	0.3	12
MRI0605	5			PP	POLYPROPYLENE				
MRI0607	7			OTHER	ALL OTHER RESINS				
MRI0600	—			ARROW SYMBOL ONLY	—				

NOTE: Additional material codes are available. Contact D-M-E for quote.