

Guided Ejection Guide Pins

Guided Ejection Guide Pins – GL

- Short press fit lengths for use in guided ejection applications
- Pins are hardened and precision ground



System 1

When pins are installed in the support plate, ejector housing can be removed from mold without removing ejector plates, permitting easy access to service the ejector system.

System 2

Pins installed in the ejector housing permit fast, low-cost installation. When ejector housing is removed from mold base, the complete ejector assembly is removed.

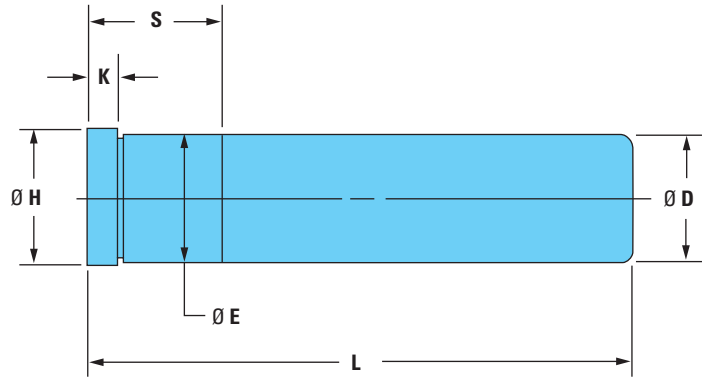

It is recommended that a minimum of four pins and bushings be installed. Size of the pins and bushings should be determined by the size of the mold. The Guided Ejection System is an inexpensive method to protect against wear and costly damage to a mold in production.

Properly installed, the D-M-E Guided Ejection System holds the ejector assembly in alignment and supports the weight of the ejector assembly throughout the entire machine cycle. This greatly reduces wear on ejection components and prevents possible cocking of the ejector plates.

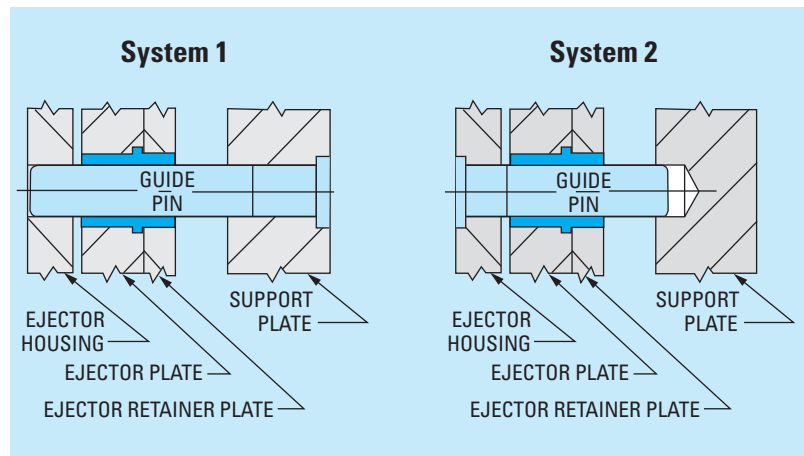

General Dimensions

NOMINAL DIA	Ø D ^{+0.000} / _{-0.005}	Ø H (MAX)	K	Ø E ^{+0.005} / _{-0.000}
3/4	.749	.990	3/16	.751
7/8	.874	1.115	1/4	.876
1"	.999	1.240	1/4	1.001
1 1/4	1.249	1.490	5/16	1.251
1 1/2	1.499	1.740	5/16	1.501

NOTES: 1. Select corresponding bronze-plated guided ejection bushings or self-lubricating guided ejection bushings in proper diameter for the application.

2. D-M-E Guided Ejection Systems are available installed in standard mold bases. For additional information and prices, contact D-M-E.

L LENGTH ^{+0.00} / _{-0.06}	Ø D = 3/4 I.D. .749 ^{+0.000} / _{-0.005}		Ø D = 7/8 I.D. .874 ^{+0.000} / _{-0.005}		Ø D = 1" I.D. .999 ^{+0.000} / _{-0.005}		Ø D = 1 1/4 I.D. 1.249 ^{+0.000} / _{-0.005}		Ø D = 1 1/2 I.D. 1.499 ^{+0.000} / _{-0.005}	
	S	ITEM NUMBER	S	ITEM NUMBER	S	ITEM NUMBER	S	ITEM NUMBER	S	ITEM NUMBER
3 3/4	7/8	5004-GL	7/8	5103-GL	7/8	5202-GL	7/8	5302-GL	1 3/8	5402-GL
4 1/4	7/8	PF-5005-GL	7/8	PF-5104-GL	7/8	PF-5203-GL	7/8	5303-GL	1 3/8	5403-GL
4 3/4	7/8	PF-5006-GL	7/8	PF-5105-GL	7/8	PF-5204-GL	1 3/8	5304-GL	1 3/8	5404-GL
5 1/4	7/8	PF-5007-GL	7/8	PF-5106-GL	7/8	PF-5205-GL	1 3/8	5305-GL	1 3/8	5405-GL
5 3/4	7/8	PF-5008-GL	7/8	PF-5107-GL	7/8	PF-5206-GL	1 3/8	5306-GL	1 3/8	5406-GL
6 1/4	—	—	—	—	—	—	1 3/8	5307-GL	1 3/8	5407-GL